

About the Adam SMARTbuilding Solution:

ADAM SMARTbuilding solutions are web enabled wireless building energy management systems that deliver best practice estates management, reducing energy consumption, maintenance costs and carbon emissions.

About the SMART Clamp On Sensor:

The Smart Clamp On Sensor is designed to be clamped directly on to pipes to monitor the temperature of water flowing within the pipe. It's additional digital channel can be used to monitor a digital output from a variety of sources such as a Smoke Alarm or volt free contacts on any number of devices. Also, the additional analogue channel can be connected to a thermistor bead in another duct or clamp sensor housing, thereby leading to a reduction in costs as only one wireless module is required.

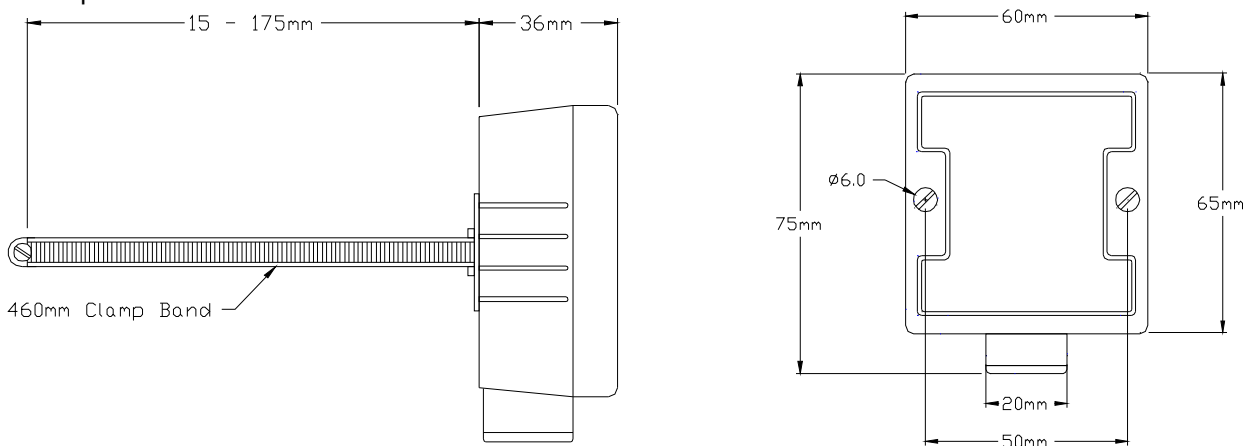

Device	Technical		Environmental	
ASD04C SMART Clamp On Sensor	Range	Wireless range of approx. 50m within buildings, 200m line of sight Signal Hopping through mains powered Adam wireless devices to extend range	Operating Temperature	-10°C to 60°C
	Communications	RF frequency range: 433.23 – 434.35 MHz or 868-870 MHz and 902-928 MHz RF Power Output: 10mW (433.23 – 434.35 MHz) 1mW (868 – 870 MHz) 1mW (902 – 928 MHz)	Storage Temperature	-30°C to 85°C
	I/O Connectivity	1 Analogue input channel with 10k Thermistor installed 1 Spare analogue input channel suitable for 10k Thermistor 1 Digital Input Channel	Cooling	Convection Cooled
	Power	9V Battery (Supplied) Power Range: 6-13.5V DC	Operating Humidity	20-80% RH
	General	IP65 Rated Enclosure Weight: 80g (including Battery) Dimensions: W 78mm x H 59mm x D 36mm	Shock	4G, 22ms, X, Y & Z axis
	Mounting	Clamps to suitable diameter pipework	Vibration	1G, 10Hz to 500Hz, X, Y & Z axis